

# HARTSLAND

MARKET SQUARE

200 Kortright Road West  
Guelph, ON



**2,042 Square Foot End Cap Unit Available For Lease**

Greg Gaudette · Broker Of Record

O:(905) 607 0719 · C:(647) 328 7027

[greg@clearstreamcre.com](mailto:greg@clearstreamcre.com)

[www.clearstreamcre.com](http://www.clearstreamcre.com)



**CLEARSTREAM**

COMMERCIAL REAL ESTATE LTD., BROKERAGE

Derek Gaudette · Broker

O:(905) 607 0719 · C:(647) 218 9321

[derek@clearstreamcre.com](mailto:derek@clearstreamcre.com)

[www.clearstreamcre.com](http://www.clearstreamcre.com)

# HARTSLAND

## MARKET SQUARE



### Location

- Hartsland Market Square is a high traffic shopping centre located at the busy intersection of Edinburgh Rd. and Kortright Rd. W. in Guelph, ON.



### Opportunity

- 2,042 Square Foot End Cap
- 35 Feet Of Frontage on To Kortright Rd. W.
- Former Restaurant with hood and walk in coolers existing.
- Drive-Thru pick-up window or patio potential available.
- Shadow anchored by Zerhs and Dollarama.



### Demographics

- Strong Demographics
- Over 150,000 population in 10KM Radius
- \$116,000 AHH Income (10km)



# HARTSLAND

## MARKET SQUARE



EDINBURGH ROAD S

RODGERS ROAD

KORTRIGHT ROAD W

Wellington Hearing Care 1,212 sf  
 Little Caesar's 1,218 sf  
 Pedi n' Nails 1,425 sf  
 Running Room 1,564 sf  
 Kortright Animal Hospital 2,784 sf

K Cleaners & Tailor Shop Limited 1,233 sf  
 Kusina Mediterranean Bistro 1,766 sf  
 Allstate Insurance Company of Canada 2,300 sf

**Zehrs**  
58,503 sf

**Scotiabank**  
4,077 sf

**DOLLARAMA**  
6,543 sf

Hartsland  
Dental  
3,009 sf

**ANYTIME FITNESS**  
6,233 sf

AVAILABLE  
2,042 sf  
Spice Roots  
2,134 sf

Pharmasave 2,337 sf  
 Seema's Beauty 1,280 sf  
 Victoria's Pizza 1,229 sf

Synergy Chiropractic 1,127 sf  
**Hasty Market** 1,632 sf  
 Zak's Jewelers 1,057 sf  
 The Fat Duck Gastro Pub 4,015 sf

# UNIT 2002

## 2,042 SQUARE FEET

IDEAL USES INCLUDE:

RESTAURANT / QSR

- CHICKEN
- CAFE
- DESSERT
- BREAKFAST
- ASIAN
- FISH + CHIPS
- SANDWICH
- BURGERS
- MEXICAN

OTHER SERVICE USES  
RETAIL  
SPECIALTY FITNESS

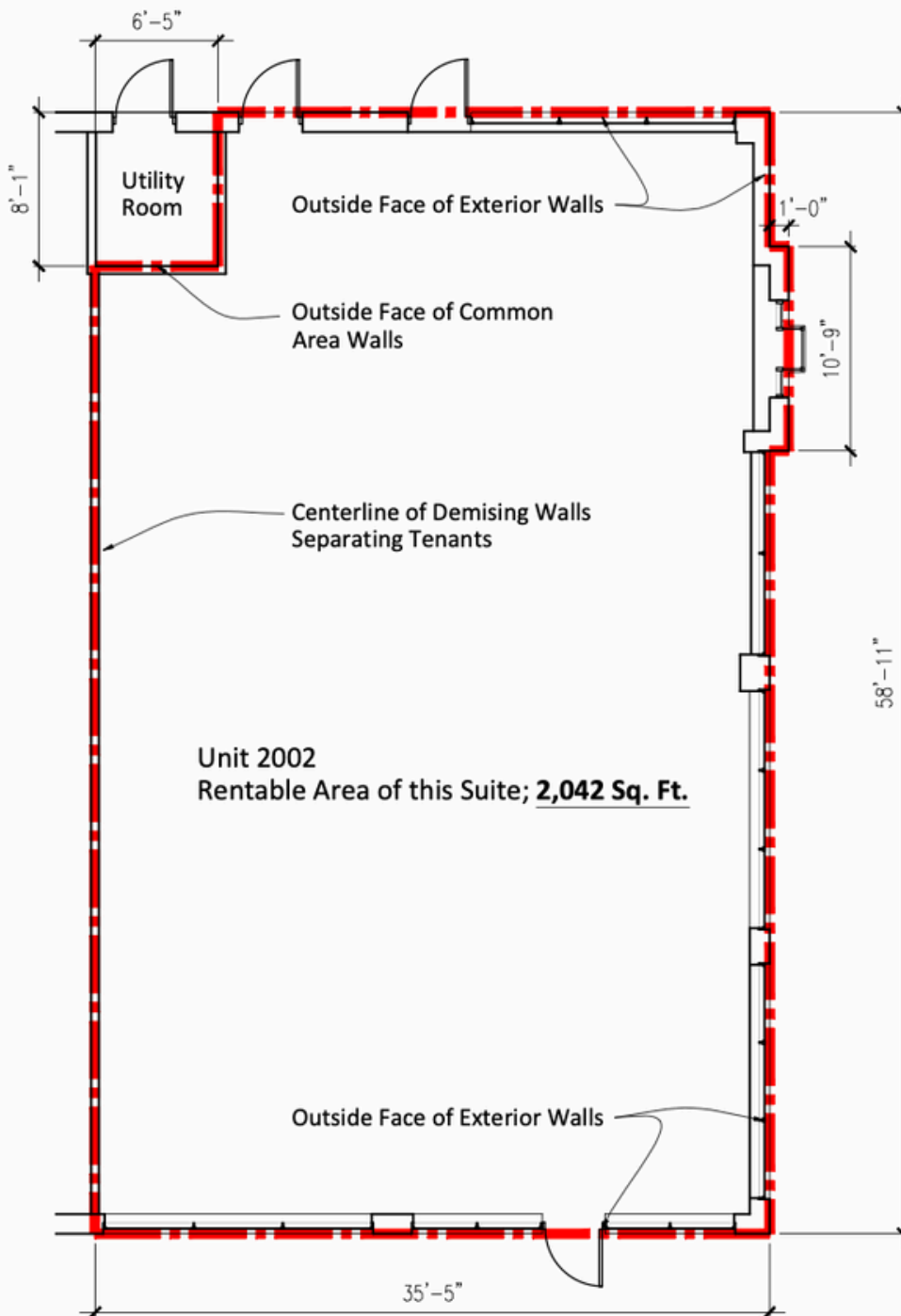

[CLICK HERE FOR VIRTUAL TOUR](#)



Greg Gaudette · Broker Of Record

O:(905) 607 0719 · C:(647) 328 7027

---

[greg@clearstreamcre.com](mailto:greg@clearstreamcre.com)

[www.clearstreamcre.com](http://www.clearstreamcre.com)



**CLEARSTREAM**

COMMERCIAL REAL ESTATE LTD., BROKERAGE

Derek Gaudette · Broker

O:(905) 607 0719 · C:(647) 218 9321

---

[derek@clearstreamcre.com](mailto:derek@clearstreamcre.com)

[www.clearstreamcre.com](http://www.clearstreamcre.com)

# DEMOGRAPHICS

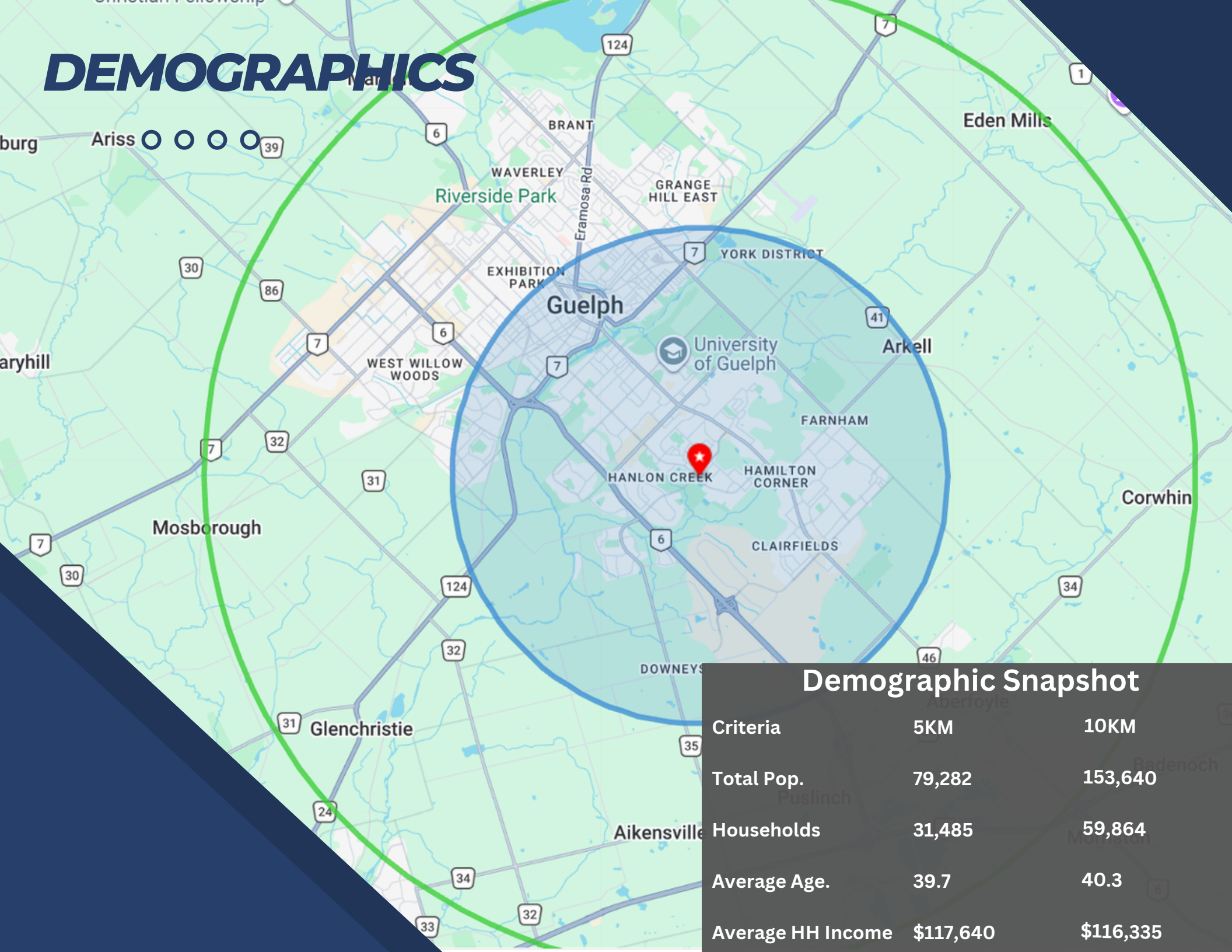

## Demographic Snapshot

Criteria	5KM	10KM
Total Pop.	79,282	153,640
Households	31,485	59,864
Average Age.	39.7	40.3
Average HH Income	\$117,640	\$116,335

# FOR LEASE

200 Kortright Road West  
Guelph, ON

For further information please contact:



**CLEARSTREAM**  
COMMERCIAL REAL ESTATE



**SKYLINE**  
RETAIL REIT

**GREG GAUDETTE**  
**BROKER OF RECORD**  
**647-328-7027**  
**GREG@CLEARSTREAMCRE.COM**

**DEREK GAUDETTE**  
**BROKER**  
**647-218-9321**  
**DEREK@CLEARSTREAMCRE.COM**

**CLEARSTREAM COMMERCIAL REAL ESTATE LTD., BROKERAGE**

6 John St., Suite 2A, Oakville, ON    905-607-0719    [www.clearstreamcre.com](http://www.clearstreamcre.com)

**DISCLAIMER**

**NO WARRANTY OR REPRESENTATION, EXPRESS OR IMPLIED, IS MADE TO THE ACCURACY OR COMPLETENESS OF THE INFORMATION CONTAINED HEREIN, AND SAME IS SUBMITTED SUBJECT TO ERRORS, OMISSIONS, CHANGE OF PRICE, RENTAL OR OTHER CONDITIONS, WITHDRAWAL WITHOUT NOTICE, AND TO ANY SPECIAL LISTING CONDITIONS IMPOSED BY THE PROPERTY OWNER(S). AS APPLICABLE, WE MAKE NO REPRESENTATION AS TO THE CONDITION OF THE PROPERTY (OR PROPERTIES) IN QUESTION**